



## CRS Data

### LOCATION

<b>Property Address</b>	105 Draper Dr Goodlettsville, TN 37072-2209
<b>Subdivision</b>	Goodlettsville Heights
<b>County</b>	Davidson County, TN

### PROPERTY SUMMARY

<b>Property Type</b>	Residential
<b>Land Use</b>	Single Family Dwelling
<b>Improvement Type</b>	Single Fam
<b>Square Feet</b>	1712

### GENERAL PARCEL INFORMATION

<b>Parcel ID/Tax ID</b>	033-04-0-024.00
<b>Alternate Parcel ID</b>	
<b>Account Number</b>	
<b>District/Ward</b>	GO
<b>2010 Census Trct/Blk</b>	103.02/1
<b>Assessor Roll Year</b>	2015

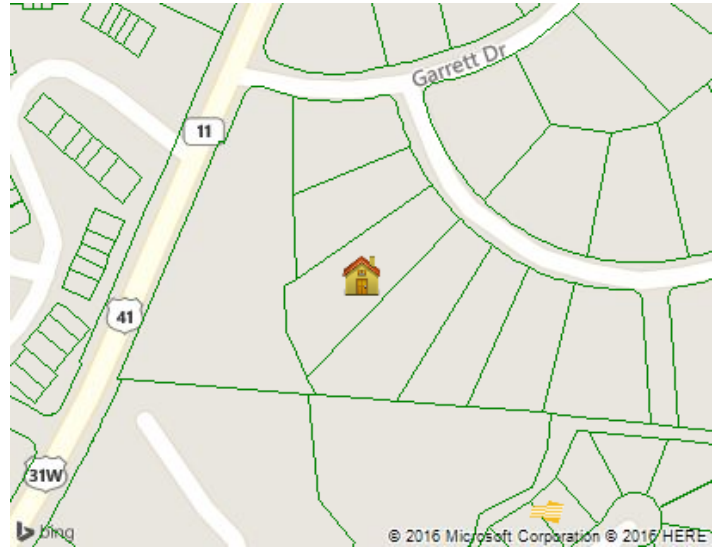

### CURRENT OWNER

<b>Name</b>	McDonald Shelby Odell
<b>Mailing Address</b>	105 Draper Dr Goodlettsville, TN 37072-2209

### SALES HISTORY THROUGH 06/09/2016

Date	Amount	Buyer/Owners	Buyer/Owners 2	Instrument	No. Parcels	Book/Page or Document#
10/21/2004	\$115,000	McDonald Shelby & Odell		Warranty Deed		200411030132389
9/5/2001	\$127,000	Goodlettsville United Pentecostal Ch		Warranty Deed		200109100098016
10/30/1991	\$75,000	Johnston Katherine W		Warranty Deed		8477/14
12/6/1989	\$71,171	Skipper Robert L Et Ux		Warranty Deed		8000/374
11/24/1987	\$65,500	Bowman Joseph Et Ux		Warranty Deed		7413/98
10/29/1959		Edwards Robert David Etux		Warranty Deed		2992/237

### TAX ASSESSMENT

Appraisal	Amount	Assessment	Amount	Jurisdiction	Rate
<b>Appraisal Year</b>	2015	<b>Assessment Year</b>	2015	<b>Goodlettsville</b>	0.9018
<b>Appraised Land</b>	\$30,800	<b>Assessed Land</b>		<b>General Service District</b>	3.924
<b>Appraised Improvements</b>	\$106,500	<b>Assessed Improvements</b>			
<b>Total Tax Appraisal</b>	\$137,300	<b>Total Assessment</b>	\$34,325		
		<b>Exempt Amount</b>			
		<b>Exempt Reason</b>			

### TAXES

Tax Year	City Taxes	County Taxes	Total Taxes
2015	\$309.54	\$1,346.91	\$1,656.45
2014	\$309.54	\$1,346.91	\$1,656.45
2013	\$301.55	\$1,346.91	\$1,648.46

## MORTGAGE HISTORY

Date	Loan Amount	Borrower	Lender	Book/Page or Document#	Assignments/ Releases
08/31/1999	\$17,000	Johnston Katherine W	Amsouth Bank	11641/255	
09/28/1998	\$82,500	Johnston Katherine W	First Signature Mtg LLC	11130/290	

## PROPERTY CHARACTERISTICS: BUILDING

## Building # 1

Type	Single Fam	Condition	Units	1	
Year Built	1953	Effective Year	1953	Stories	1
BRs	2	Baths	1 F H	Rooms	6
Total Sq. Ft.	1,712				
Building Square Feet (Living Space)			Building Square Feet (Other)		
First Story (Base) 1,427					

## - CONSTRUCTION

Quality		Roof Framing	
Shape		Roof Cover Deck	
Partitions		Cabinet Millwork	
Common Wall		Floor Finish	
Foundation	Crawl/Raised	Interior Finish	
Floor System		Air Conditioning	Central
Exterior Wall	Brick	Heat Type	Heat & Cooling Pkg.
Structural Framing		Bathroom Tile	
Fireplace		Plumbing Fixtures	

## - OTHER

Occupancy	Building Data Source
-----------	----------------------

## PROPERTY CHARACTERISTICS: EXTRA FEATURES

Feature	Size or Description	Year Built	Condition
Det Canopy	18X20		
Att Br Gar Unf	500		
Open Pch	54		
Screen Pch	180		
Attic Fin	285		

## PROPERTY CHARACTERISTICS: LOT

Land Use	Single Family Dwelling	Lot Dimensions	80 X 401
Block/Lot	/26	Lot Square Feet	43,124
Latitude/Longitude	36.300228°/-86.720210°	Acreage	0.99

## PROPERTY CHARACTERISTICS: UTILITIES/AREA

Gas Source		Road Type	
Electric Source		Topography	
Water Source		District Trend	
Sewer Source		Special School District 1	
Zoning Code	6Zz: City Of Goodlettsville	Special School District 2	
Owner Type			

## LEGAL DESCRIPTION

<b>Subdivision</b>	Goodlettsville Heights	<b>Plat Book/Page</b>	
<b>Block/Lot</b>	/26	<b>District/Ward</b>	GO
<b>Description</b>	Lot 26 Sec 3 Gville Hgts / Neighborhood Code And Name: 9326 Goodlettsville		

## FLOOD ZONE INFORMATION

<b>Zone Code</b>	<b>Flood Risk</b>	<b>BFE</b>	<b>Description</b>	<b>FIRM Panel ID</b>	<b>FIRM Panel Eff. Date</b>
X	Minimal		Area of minimal flood hazard, usually depicted on FIRMs as above the 500-year flood level.	47037C0136F	04/20/2001